



Vyntus™ BODY
body plethysmography

Technical data

Box

Material	Aluminium / glass construction
Principle	Volume-constant
Volume	1110 L
Height step-in	70 mm (2.8")
Weight	175 kg (385 lbs)
(W x outside)	932 × 800 × 1850 mm (<i>incl. door handle</i>) (36.7" × 31.5" × 72.8")
(W x inside)	882 × 705 × 1739 mm (34.7" × 27.8" × 68.5")
Mains voltage	100 to 240 V, AC 50 to 60 Hz
Electrical safety	Protection class I

Flow measurement

Type	Ultrasound
Sample rate	1000 Hz, achieved by 2000 ultrasound transit time measurements (<i>double shot technology</i>)
Range	0 to 18 L / s bidirectional
Accuracy	Exhalation 0 to 14 L / s: 1.5% or 0.05 L / s (<i>whichever is greater</i>) Inhalation 0 to 14 L / s: 2.0 % or 0.05 L / s (<i>whichever is greater</i>)
Total resistance (<i>MicroGard® II filter + USS Module + FPV block</i>)	<0.150 kPa*s/L at 14 L / s <1.53 cmH2O*s/L
Dead space USS Module	66 mL

Volume integration

Principle	Software volume integration of flow signal
Range	30 L (<i>software limited</i>)
Accuracy	Exhalation and inhalation 0.5 to 14 L/s: 2.5% or 0.075 L (75 mL)
Precision	1% or 0.05 L (<i>whichever is greater</i>)

Bench

Maximal load bench	250 kg (551 lbs)
Sitting height	47.6 cm (18.7")
Sitting area	50.6 cm W x 33.0 cm D (19.9" x 13.0")
Material bench	POM (Polyoxymethylene)

Flexible 3D Arm

Max. length outside the cabin	63 cm (24.8")
Adjustable height inside the cabin	98.3 cm to 141.5 cm (38.7" to 55.7")

Multigas analyzer (CO / CH4) – Diffusion measurement

Type	Infrared
Range	0 to 0.33 vol %
Accuracy	± 0.003 vol % or ± 2 % relative (<i>whichever is greater</i>)
Resolution	0.0005 vol %

Ambient measurement	Measurement range	Accuracy
Temperature sensor	- 10 to 50 °C (14 to 122 °F)	± 0.5 °C at 20 °C (68 °F) ± 1 °C at 10 to 34 °C (50 to 93.2 °F)
Humidity sensor	0 to 100 % relative humidity	4 % relative humidity at 20 – 80 % relative humidity
Air pressure sensor	500 to 1100 hPa (375 to 825 mmHg)	± 2.5 hPa (1.88 mmHg) at 700 to 1060 hPa (525 to 795 mmHg)

Dimensions/weight of standard cart

Dimensions total	61 W x 62 cm D x 172 - 197 cm (depending on monitor assembly) (24" x 24.4" x 67.7 - 77.6")	
Weight total	(130 lbs; 59kg) inclusive PC, printer and 24" LCD monitor	
Shelves	Number	2
	Load capacity	20 kg (44 lbs) distributed load
Keyboard drawer with mousepad (left / right)	Keyboard platform area	40 cm W x 20 cm D (15.7" x 7.9")
Mechanical height adjustment for keyboard/mouse and monitor	Range	30 cm (11.81")
Monitor mount	Load capacity	24" or 32"
Mains voltage	115 V AC/230 V AC, 50/60 Hz	
Power input	690 VA	
Electrical safety	Protection class I	

Ambient conditions

Temperature	+ 10 °C to + 34 °C (+ 50 °F to 93.2 °F)	
Relative humidity	20 to 80 % RH, non-condensing	
Ambient pressure	700 to 1060 hPa (525 to 795 mmHg)	
Altitude	≤ 3000 m (9842 ft)	

Moisture protection

Vyntus BODY	IP 20	
CART	No IP protection	
Ultra Sound Sensor (USS Module)	IP 67	

Classification of applied parts

Vyntus BODY	Type applied part	B
-------------	-------------------	---

Category according to MDD 93/42/EEC (2007)

Complete system	Active class IIa medical product	
-----------------	----------------------------------	--

Operating mode

Complete system	Continuous operation
-----------------	----------------------

Standards, directives

Standards	EN 60601-1, EN 60601-1-2, EN 62304, EN 62366, EN ISO 14971, EN ISO 10993-1
Directives	93/42/EEC amended by 2007/47/EC, RoHS 2011 / 65 / EU compliant
Market clearances	FDA 510(k) clearance

Required space

Vyntus® BODY with standard cart

Space requirements: 180 × 160 cm (70.9" x 63.0")

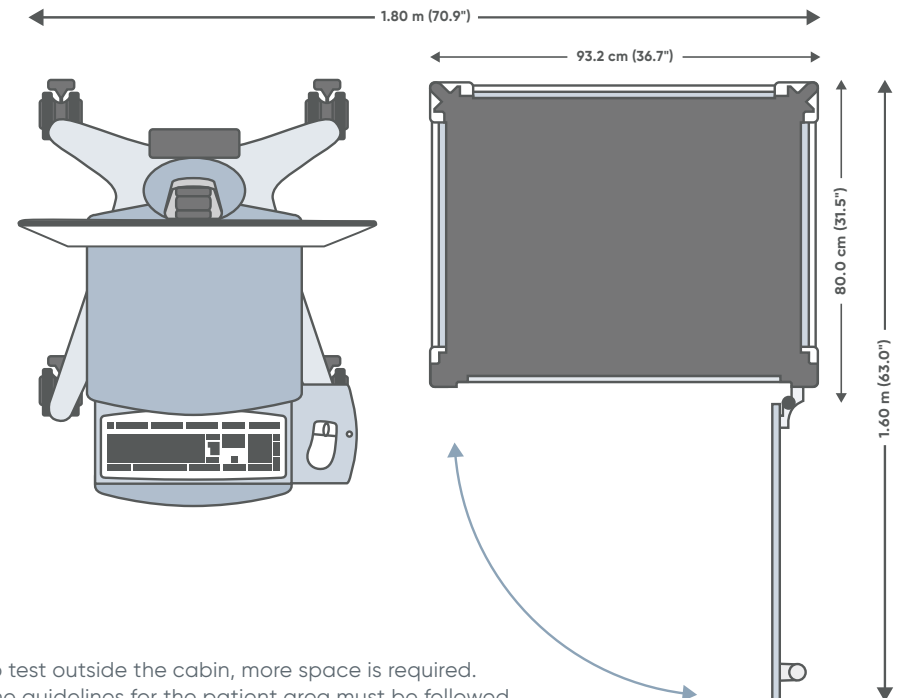

To test outside the cabin, more space is required. The guidelines for the patient area must be followed.



GLOBAL HEADQUARTERS

Vyairē Medical, Inc.
26125 North Riverwoods Blvd
Mettawa, IL 60045
USA

vyairē.com

 **For U.S. distribution only**

© 2018 Vyairē. Vyairē, the Vyairē logo and Vyntus are trademarks or registered trademarks of Vyairē Medical, Inc., or one of its affiliates. VYR-US-1800007